

CRAIGSHIRE PLAZA OFFICE BUILDING

1850 Craigshire Road Saint Louis, Missouri 63146

FOR LEASE



CRAIGSHIRE ◆ PLAZA ◆

TOTAL BUILDING SIZE: 61,374 Square Foot Office Building

AVAILABILITY: Immediate

AVAILABLE SPACE:

- 5,579 rsf Suite 100
- 3,664 rsf Suite 101
- 2,262 rsf Suite 200
- 3,308 rsf Suite 200a
- 2,555 rsf Suite 201
- 1,521 rsf Suite 205

PARKING: Parking Ratio 4.0 per 1,000 rsf

ADDITIONAL INFO:

- Access provided by Security Card
- Professional Onsite Property Management
- Fiber Optics Available
- Covered Parking available
- Outstanding Shopping, Restaurants, and Hotels minutes away

**EASY ACCESS TO
PAGE EXTENSION**

I-70

HWY 40

I-270

**and minutes from
ST. CHARLES COUNTY**



For information contact Jim J. Otis: 314-434-4004 jjotis@otisandclark.com

1850 Craigshire Road, Suite 103, Saint Louis, MO 63146
314.434.4004 phone 314.434.4113 fax www.otisandclark.com



CRAIGSHIRE PLAZA OFFICE BUILDING

1850 Craigshire Road Saint Louis, Missouri 63146

CRAIGSHIRE

◆ PLAZA ◆

1st Floor

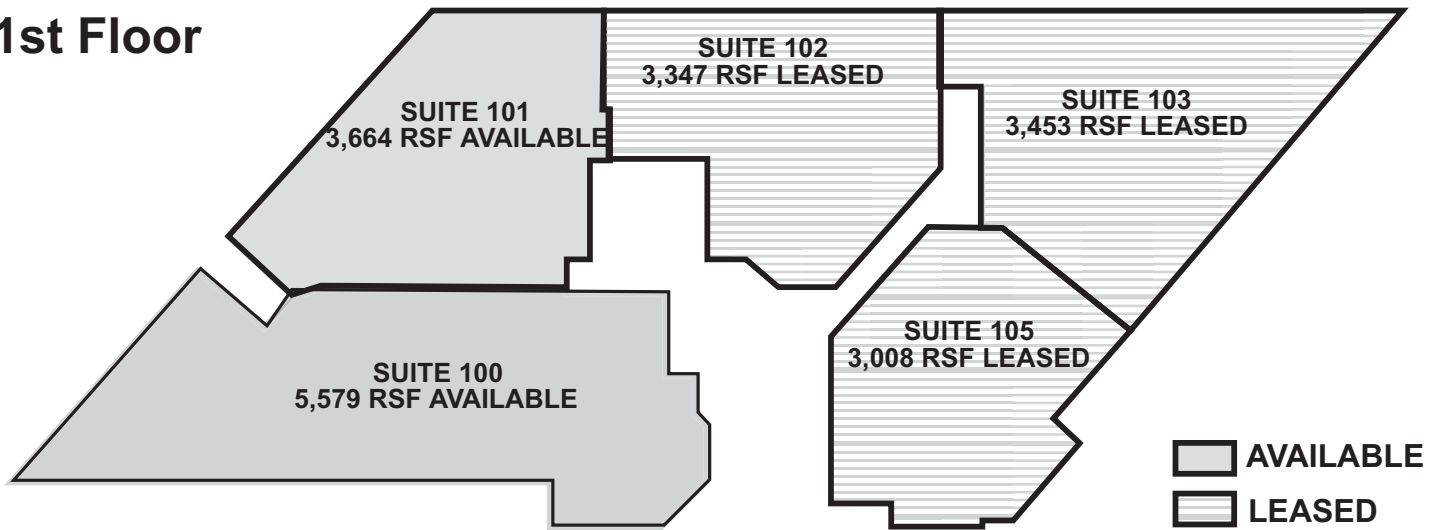

2nd Floor

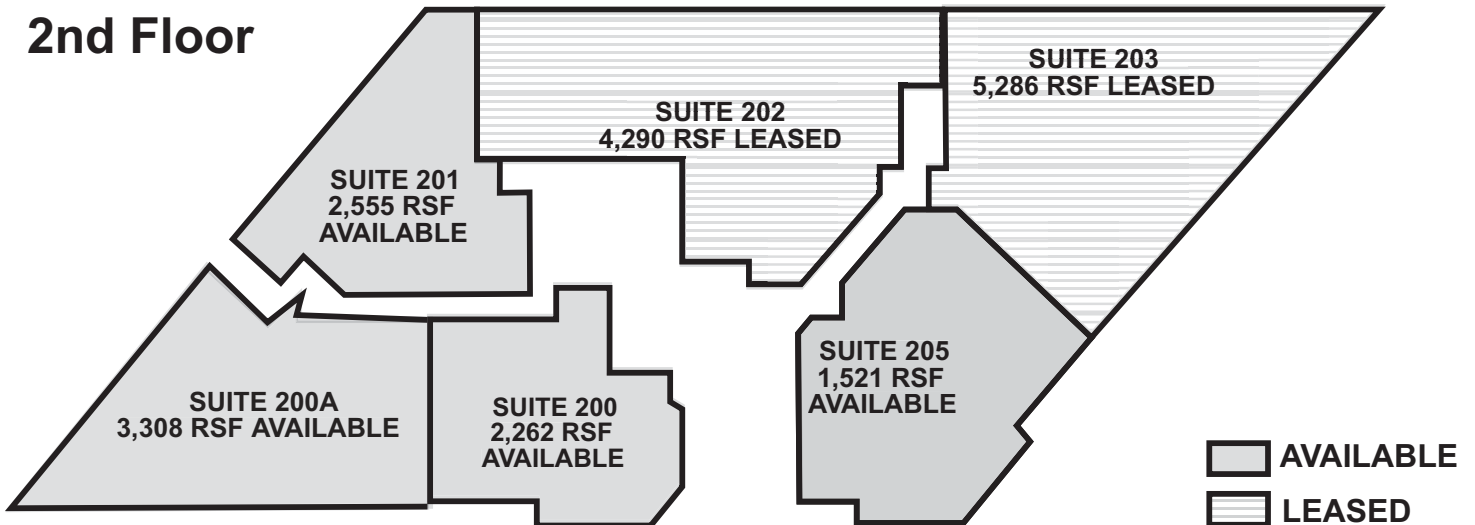

3rd Floor

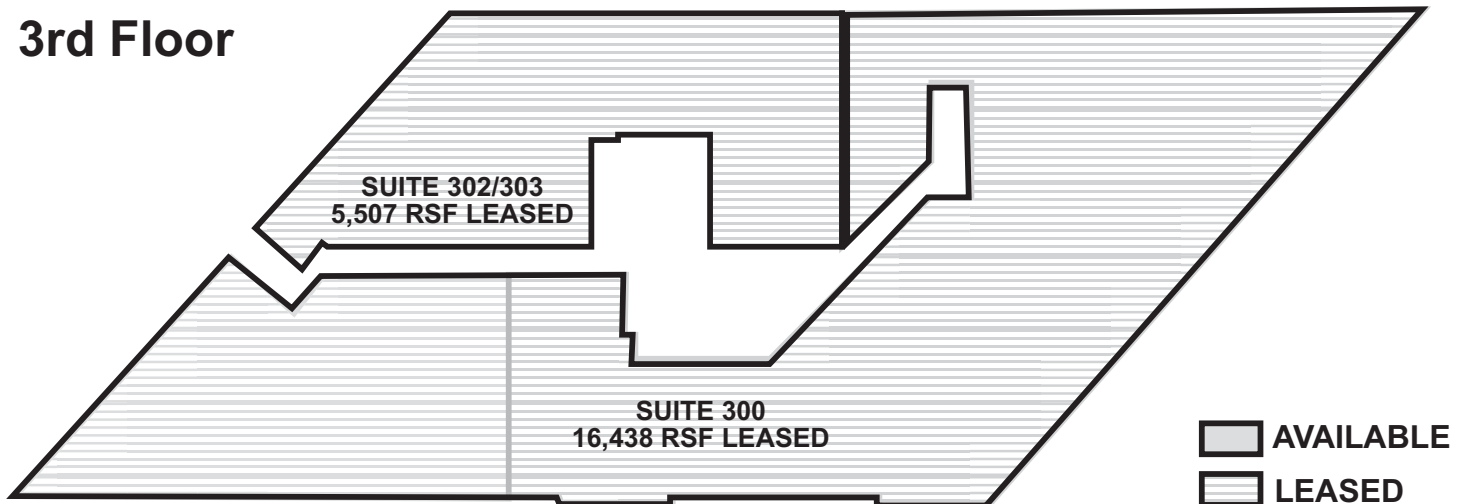

For information contact Jim J. Otis: 314-434-4004 jjotis@otisandclark.com

1850 Craigshire Road, Suite 103, Saint Louis, MO 63146

314.434.4004 phone 314.434.4113 fax www.otisandclark.com



Otis & Clark Properties